

Fines Separator

Manual P/N 397 379 A
– English –

Issued 05/03

Keep for Future Reference



NORDSON (UK) LTD. • STOCKPORT

Order number

P/N = Order number for Nordson products

Notice

This is a Nordson Corporation publication which is protected by copyright. Original copyright date 2003. No part of this document may be photocopied, reproduced, or translated to another language without the prior written consent of Nordson Corporation. The information contained in this publication is subject to change without notice.

© 2003 All rights reserved.

Trademarks

AccuJet, AeroCharge, AquaGuard, Asymtek, Automove, Autotech, Baitgun, Blue Box, CanWorks, Century, CF, Clean Coat, CleanSleeve, CleanSpray, Control Coat, Cross-Cut, Cyclo-Kinetic, Dispensejet, DispenseMate, Durafiber, Durasystem, Easy Coat, Easymove Plus, Econo-Coat, EFD, ETI, Excel 2000, FlexiCoat, Flexi-Spray, Flex-O-Coat, Flow Sentry, Fluidmove, FoamMelt, FoamMix, Heli-flow, Helix, Horizon, Hot Shot, Isocoil, Isocore, Iso-Flo, JR, KB30, Kinetix, Little Squirt, Magnastatic, MEG, Meltex, Microcoat, Micromark, MicroSet, Millenium, Mini Squirt, Moist-Cure, Mountaingate, MultiScan, Nordson, OmniScan, OptiMix, Package of Values, Patternview, Plasmod, PluraFoam, Porous Coat, PowderGrid, Powderware, Prism, Pro-Flo, ProLink, Pro-Meter, Pro-Stream, PRX, RBX, Rhino, Saturn, SC5, S. design stylized, Seal Sentry, Select Charge, Select Coat, Select Cure, Slaughterback, Smart-Coat, Solder Plus, Spectrum, Spraymelt, Spray Squirt, Super Squirt, Sure Coat, Tela-Therm, Tracking Plus, Trends, Tribomatic, UniScan, UpTime, Veritec, Versa-Coat, Versa-Screen, Versa-Spray, Walcom, Watermark, When you expect more. are registered trademarks – ® – of Nordson Corporation.

AeroDeck, AeroWash, Apogee, ATS, Auto-Flo, AutoScan, BetterBook, CanNeck, Chameleon, Check Mate, ColorMax, Controlled Fiberization, Control Weave, CoolWave, CPX, Dry Cure, DuraBlue, Dura-Coat, Dura-Screen, Easy Clean, Eclipse, EcoDry, E-Nordson, Equi-Bead, ESP, Fillmaster, Fill Sentry, Gluie, iControl, iFlow, Ink-Dot, iON, Iso-Flex, iTrend, KVLP, Lacquer Cure, March, Maxima, MicroFin, MicroMax, Minimater, Multifil, Origin, PermaFlo, PluraMix, Powder Pilot, Powercure, Primarc, ProBlue, Process Sentry, Pulse Spray, PurTech, Ready Coat, Scoreguard, Select Series, Sensomatic, Shaftshield, SheetAire, Spectral, Spectronic, Speed-Coat, Speedking, Spray Works, Summit, SureBead, Sure Brand, Sure Clean, Sure-Max, Swirl Coat, Tempus, ThruWave, Trade Plus, Universal, VersaBlue, Vista, Web Cure, 2 Rings (Design) are trademarks – ® – of Nordson Corporation.

Designations and trademarks stated in this document may be brands that, when used by third parties for their own purposes, could lead to violation of the owners' rights.

Declaration of Conformity

98/37/EC

73/23/EEC

We,

Nordson (U.K.) Limited

of

**Ashurst Drive, Cheadle Heath, Stockport, Cheshire, SK3 0RY,
United Kingdom**

declare that under our sole responsibility for supply/manufacture of the product(s)

Product Name Fines Separator

Model Number(s) Z0900AS6326

Product Options All

to which this declaration relates, is in conformity with the following standards and other normative documents

Safety BS EN 60204-1:1993
"Safety of Machinery – Electrical equipment of machines"

EN 60335:Part 1:1988
"Safety of household and similar electrical appliances"

BS EN 292:1991
"Safety of machinery – Basic concepts, general principles for design"

following the provisions of 98/37/EC and 73/23/EEC Directives

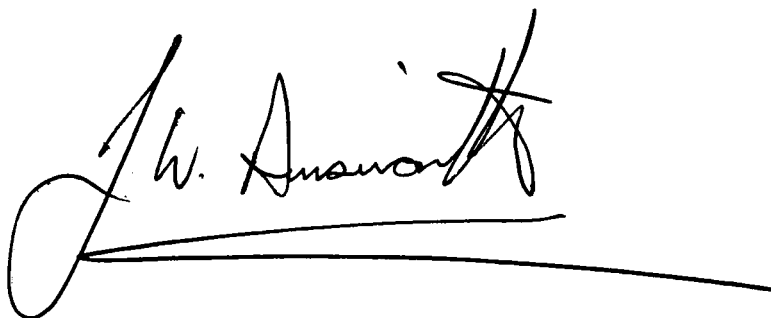
A handwritten signature in black ink, appearing to read 'J. Ainsworth', with a long horizontal line extending from the end of the signature.

Jim Ainsworth
General Manager

Nordson (U.K.) Ltd., 1st March 2003

NB rif EN45014 (BS7514)

Table of Contents

Congratulations on the Purchase of Your Nordson Product	0-1
Your Safety is Important to Nordson	0-1
Manufacturer of Equipment	0-1
 Nordson International	 0-3
Europe	0-3
Distributors in Eastern & Southern Europe	0-3
Outside Europe / Hors d'Europe / Fuera de Europa	0-4
Africa / Middle East	0-4
Asia / Australia / Latin America	0-4
Japan	0-4
North America	0-4
 Safety	 1-1
Introduction	1-1
Qualified Personnel	1-1
Intended Use	1-1
Regulations and Approvals	1-2
Personal Safety	1-2
Fire Safety	1-3
Grounding	1-3
Action in the Event of a Malfunction	1-4
Disposal	1-4
 Introduction	 2-1
Intended Use	2-1
Improper Use	2-2
Residual Risks	2-2
Features	2-2
 Installation	 3-1
Setting Up the Unit	3-1
Electrical System	3-4
Pneumatic System	3-4
 Operation	 4-1
Initial Startup	4-1
Daily Operation	4-2

Maintenance	5-1
Daily Maintenance	5-1
Annual Maintenance	5-1
Replacing the Cartridge Filter	5-2
Installing a New Cartridge Filter	5-3
 Troubleshooting	 6-1
Introduction	6-1
 Parts	 7-1
Introduction	7-1
Using the Illustrated Parts List	7-1
Parts List	7-2
 Technical Data	 8-1
Electrical	8-1
Dimension	8-1
Packaging and Handling	8-2
Noise	8-2
Pneumatic	8-2

Congratulations on the Purchase of Your Nordson Product

Nordson equipment is engineered and manufactured in accordance with strict specifications, using high quality components and state-of-the-art technologies that assure reliable, long-term performance. Your product was thoroughly tested for proper operation prior to shipment.

Before unpacking and installing your new equipment, please read this manual. It is your guide to safe installation, productive operation and effective maintenance. We recommend that you keep the manual available for future reference.

Your Safety is Important to Nordson

Carefully read the *Safety* section. Your product is designed for safe operation when used according to the published instructions. Potential hazards exist when operating instructions are not followed.

Manufacturer of Equipment

Nordson (U.K.) Ltd.
Ashurst Drive
Cheadle Heath
Stockport
England
SK3 0RY

Telephone: 0044 (0) 161-495-4200
Fax: 0044 (0) 161-428-3695

For a list of local Nordson organisations, see *Nordson International*.

Nordson International

Europe

Country		Phone	Fax
Austria		43-1-707 5521	43-1-707 5517
Belgium		31-13-511 8700	31-13-511 3995
Czech Republic		4205-4159 2411	4205-4124 4971
Denmark	<i>Hot Melt</i>	45-43-66 0123	45-43-64 1101
	<i>Finishing</i>	45-43-66 1133	45-43-66 1123
Finland		358-9-530 8080	358-9-530 80850
France		33-1-6412 1400	33-1-6412 1401
Germany	<i>Erkrath</i>	49-211-92050	49-211-254 658
	<i>Lüneburg</i>	49-4131-8940	49-4131-894 149
	<i>Düsseldorf - Nordson UV</i>	49-211-3613 169	49-211-3613 527
Italy		39-02-904 691	39-02-9078 2485
Netherlands		31-13-511 8700	31-13-511 3995
Norway	<i>Hot Melt</i>	47-23 03 6160	47-22 68 3636
	<i>Finishing</i>	47-22-65 6100	47-22-65 8858
Poland		48-22-836 4495	48-22-836 7042
Portugal		351-22-961 9400	351-22-961 9409
Russia		7-812-11 86 263	7-812-11 86 263
Slovak Republic		4205-4159 2411	4205-4124 4971
Spain		34-96-313 2090	34-96-313 2244
Sweden	<i>Hot Melt</i>	46-40-680 1700	46-40-932 882
	<i>Finishing</i>	46 (0) 303 66950	46 (0) 303 66959
Switzerland		41-61-411 3838	41-61-411 3818
United Kingdom	<i>Hot Melt</i>	44-1844-26 4500	44-1844-21 5358
	<i>Finishing</i>	44-161-495 4200	44-161-428 6716
	<i>Nordson UV</i>	44-1753-558 000	44-1753-558 100

Distributors in Eastern & Southern Europe

DED, Germany	49-211-92050	49-211-254 658
---------------------	--------------	----------------

**Outside Europe /
Hors d'Europe /
Fuera de Europa**

- For your nearest Nordson office outside Europe, contact the Nordson offices below for detailed information.
- Pour toutes informations sur représentations de Nordson dans votre pays, veuillez contacter l'un de bureaux ci-dessous.
- Para obtener la dirección de la oficina correspondiente, por favor diríjase a unas de las oficinas principales que siguen abajo.

Contact Nordson	Phone	Fax
-----------------	-------	-----

Africa / Middle East

DED, Germany	49-211-92050	49-211-254 658
--------------	--------------	----------------

Asia / Australia / Latin America

Pacific South Division, USA	1-440-988-9411	1-440-985-3710
--------------------------------	----------------	----------------

Japan

Japan	81-3-5762 2700	81-3-5762 2701
-------	----------------	----------------

North America

Canada		1-905-475 6730	1-905-475 8821
USA	Hot Melt	1-770-497 3400	1-770-497 3500
	Finishing	1-440-988 9411	1-440-985 1417
	Nordson UV	1-440-985 4592	1-440-985 4593

Section 1

Safety

Introduction

Read and follow these safety instructions. Task- and equipment-specific warnings, cautions, and instructions are included in equipment documentation where appropriate.

Make sure all equipment documentation, including these instructions, is accessible to all persons operating or servicing equipment.

Qualified Personnel

Equipment owners are responsible for making sure that Nordson equipment is installed, operated, and serviced by qualified personnel. Qualified personnel are those employees or contractors who are trained to safely perform their assigned tasks. They are familiar with all relevant safety rules and regulations and are physically capable of performing their assigned tasks.

Intended Use

Use of Nordson equipment in ways other than those described in the documentation supplied with the equipment may result in injury to persons or damage to property.

Some examples of unintended use of equipment include

- using incompatible materials
- making unauthorized modifications
- removing or bypassing safety guards or interlocks
- using incompatible or damaged parts
- using unapproved auxiliary equipment
- operating equipment in excess of maximum ratings

Regulations and Approvals

Make sure all equipment is rated and approved for the environment in which it is used. Any approvals obtained for Nordson equipment will be voided if instructions for installation, operation, and service are not followed.

All phases of equipment installation must comply with all federal, state, and local codes.

Personal Safety

To prevent injury follow these instructions.

- Do not operate or service equipment unless you are qualified.
- Do not operate equipment unless safety guards, doors, or covers are intact and automatic interlocks are operating properly. Do not bypass or disarm any safety devices.
- Keep clear of moving equipment. Before adjusting or servicing any moving equipment, shut off the power supply and wait until the equipment comes to a complete stop. Lock out power and secure the equipment to prevent unexpected movement.
- Relieve (bleed off) hydraulic and pneumatic pressure before adjusting or servicing pressurized systems or components. Disconnect, lock out, and tag switches before servicing electrical equipment.
- Obtain and read Material Safety Data Sheets (MSDS) for all materials used. Follow the manufacturer's instructions for safe handling and use of materials, and use recommended personal protection devices.
- To prevent injury, be aware of less-obvious dangers in the workplace that often cannot be completely eliminated, such as hot surfaces, sharp edges, energized electrical circuits, and moving parts that cannot be enclosed or otherwise guarded for practical reasons.

Fire Safety

To avoid a fire or explosion, follow these instructions.

- Do not smoke, weld, grind, or use open flames where flammable materials are being used or stored.
- Provide adequate ventilation to prevent dangerous concentrations of volatile materials or vapors. Refer to local codes or your material MSDS for guidance.
- Do not disconnect live electrical circuits while working with flammable materials. Shut off power at a disconnect switch first to prevent sparking.
- Know where emergency stop buttons, shutoff valves, and fire extinguishers are located. If a fire starts in a spray booth, immediately shut off the spray system and exhaust fans.
- Clean, maintain, test, and repair equipment according to the instructions in your equipment documentation.
- Use only replacement parts that are designed for use with original equipment. Contact your Nordson representative for parts information and advice.

Grounding



PERICOLO: Operating faulty electrostatic equipment is hazardous and can cause electrocution, fire, or explosion. Make resistance checks part of your periodic maintenance program. If you receive even a slight electrical shock or notice static sparking or arcing, shut down all electrical or electrostatic equipment immediately. Do not restart the equipment until the problem has been identified and corrected.

All work conducted inside the spray booth or within 1 m (3 ft) of booth openings is considered within a Class 2, Division 1 or 2 Hazardous location and must comply with NFPA 33, NFPA 70 (NEC articles 500, 502, and 516), and NFPA 77, latest conditions.

- All electrically conductive objects in the spray areas shall be electrically connected to ground with a resistance of not more than 1 megohm as measured with an instrument that applies at least 500 volts to the circuit being evaluated.

Grounding *(contd.)*

- Equipment to be grounded includes, but is not limited to, the floor of the spray area, operator platforms, hoppers, photoeye supports, and blow-off nozzles. Personnel working in the spray area must be grounded.
- There is a possible ignition potential from the charged human body. Personnel standing on a painted surface, such as an operator platform, or wearing non-conductive shoes, are not grounded. Personnel must wear shoes with conductive soles or use a ground strap to maintain a connection to ground when working with or around electrostatic equipment.
- Operators must maintain skin-to-handle contact between their hand and the gun handle to prevent shocks while operating manual electrostatic spray guns. If gloves must be worn, cut away the palm or fingers, wear electrically conductive gloves, or wear a grounding strap connected to the gun handle or other true earth ground.
- Shut off electrostatic power supplies and ground gun electrodes before making adjustments or cleaning powder spray guns.
- Connect all disconnected equipment, ground cables, and wires after servicing equipment.

Action in the Event of a Malfunction

If a system or any equipment in a system malfunctions, shut off the system immediately and perform the following steps:

- Disconnect and lock out electrical power. Close pneumatic shutoff valves and relieve pressures.
- Identify the reason for the malfunction and correct it before restarting the equipment.

Disposal

Dispose of equipment and materials used in operation and servicing according to local codes.

Section 2

Introduction

Intended Use

The filter described in this manual is designed to be installed in multi colour booth powder recovery systems.

Installed downstream of the cyclone, it receives the bleed and removes the fine part of recycled or virgin powders.

The pickup is obtained by directly connecting the filter to the booth filtering module.

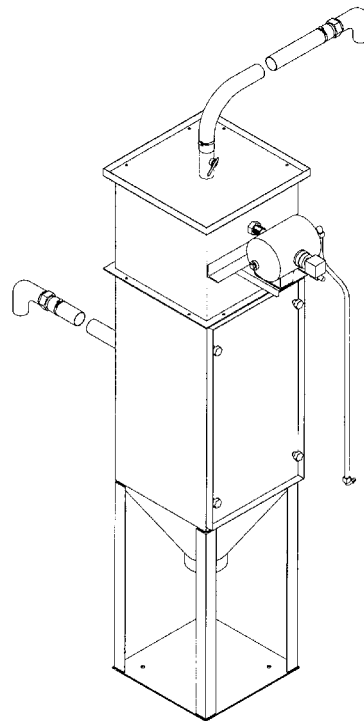

Fig. 2-1

Improper Use

Use of the filter other than what described above is regarded as improper and therefore not conforming with the regulations in force.

Residual Risks

Nordson knows of no specific residual risks associated to this equipment; the operator should therefore carefully read the section relating to general safety and any specific warnings contained in this manual.

Features

The filter, made of powder coated soft steel or – in the case of glass enamel systems – of outside powder coated steel, is especially designed to remove the fine part of recirculating powder.

It consists of a complete hopper structure for powder recovery and of a valve body supporting the cartridge filter cleaning system.

A compressed air tank is fitted outside the valve body to operate the cartridge filter cleaning system; the tank is provided with cleaning valves, special air injection nozzles and all of the components required for operation.

A suitably sized bag should be placed below the hopper to collect the powder and then delivery it for disposal.

A large door is provided onto the structure for inspection purpose and when the cartridge filter needs replacement.

The structure is provided with mechanical locking devices to attach the cartridge filter to the top support plate.

Section 3

Installation



WARNING: Allow only qualified personnel to perform the following tasks. Observe and follow the safety instructions in this document and all other related documentation.

Setting Up the Unit

1. Unpack the filter.

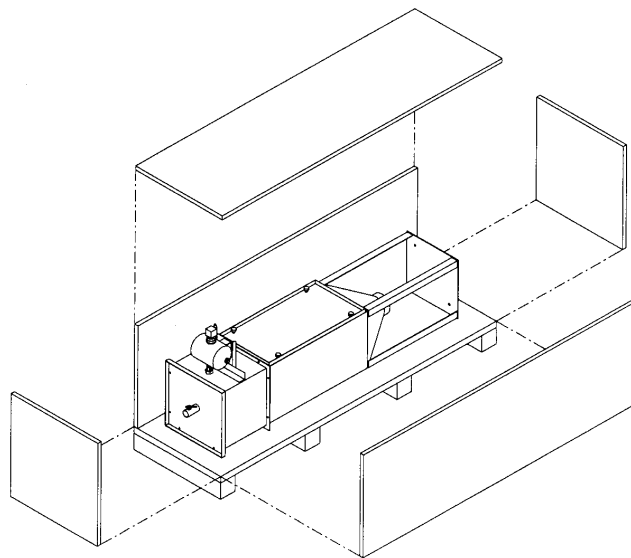

Fig. 3-2

Setting Up the Unit *(cont.)*

2. Lift the filter to place it in vertical position.

NOTE: If the unit weight is not high, this operation can be carried out without using the normal lifting means.

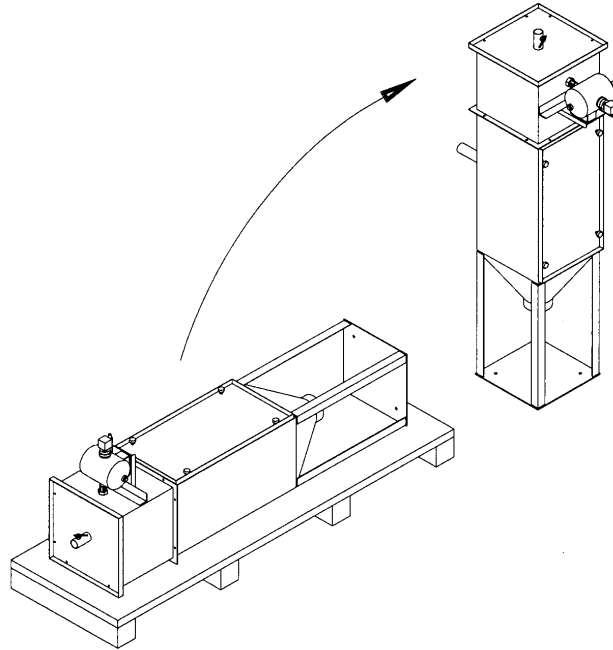

Fig. 3-3

3. Move the filter to its work position as shown on the overall layout.

NOTE: If the unit weight is not high, this operation can be carried out without using the normal lifting means.

4. Install the air pickup connection tubes as shown and connect the tank to the compressed air supply.

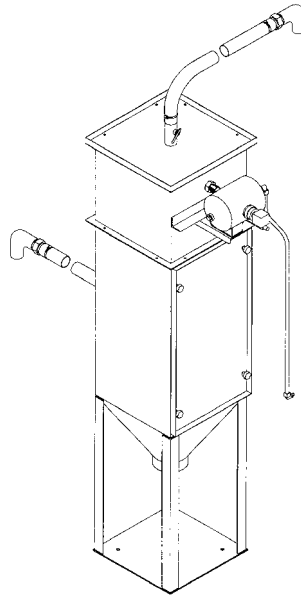

Fig. 3-4

5. Connect the inlet tube –A– to the mini cyclone and the outlet tube –B– to the filter module.

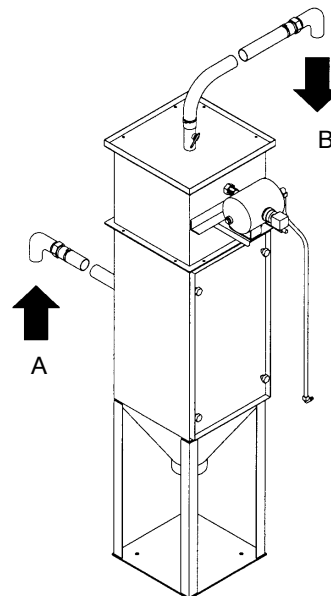

Fig. 3-5

If you need support, contact the nearest Nordson Customer Service Center.

Electrical System



WARNING: Risk of electrical shock. Failure to observe may result in personal injury, death, or equipment damage.

1. Ensure that all electrical connections have been tested in compliance with the regulations in force before starting the unit.
2. Solenoid valve supply with 24 VAC timer.
3. Solenoid valve supply from the master panel cleaning board 24 VDC.

Pneumatic System

1. Implement the connections as shown on the pneumatic schematic provided.
2. The parameters for a proper pneumatic connection are as follows:
 - tank supply tube section **8x10 mm**
 - tank supply pressure to ensure a proper cartridge cleaning **2–3 bar**

Section 4

Operation



WARNING: Allow only qualified personnel to perform the following tasks. Observe and follow the safety instructions in this document and all other related documentation.

Initial Startup

1. Check the valve body tank air supply.
2. Check the proper connection of the air pickup and delivery tubes.
3. Properly adjust the air lock –A– located above the plenum for a correct filter pressure relief.

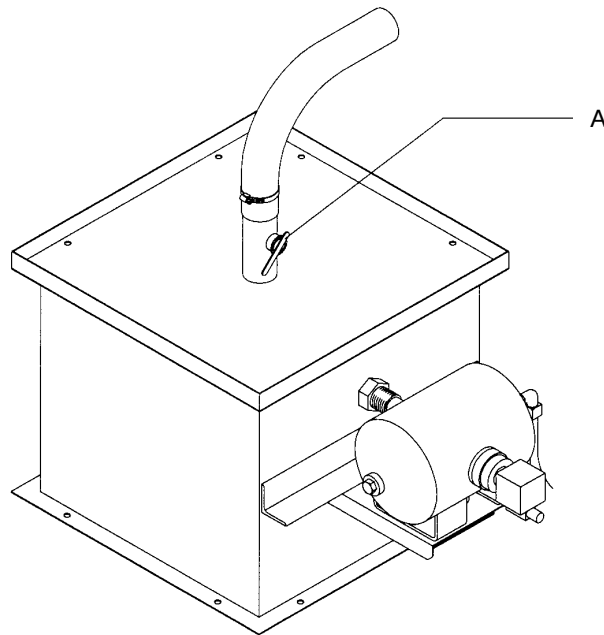

Fig. 4-1

Daily Operation

The filter is designed to automatically stop and start with the spray booth and its recycle system. Ensure that the unit is off on the control panel and let it stand for a minute before opening the door.



WARNING: Breathing in certain airborne dusts (including finishing powders) may be hazardous to health. Ask the powder manufacturer for a Material Safety Data Sheet (MSDS) for information. Use appropriate respiratory protection.

Section 5

Maintenance



WARNING: Allow only qualified personnel to perform the following tasks. Observe and follow the safety instructions in this document and all other related documentation.



WARNING: Breathing in certain airborne dusts (including finishing powders) may be hazardous to health. Ask the powder manufacturer for a Material Safety Data Sheet (MSDS) for information. Use appropriate respiratory protection.

Daily Maintenance

1. Check the inspection door seals.
2. Check the air tube fitting seals.
3. Check the presence of powders in the collection bag and remove it, if required.
4. Clean the outside of the filter.

Annual Maintenance

1. Check the cartridge filter and replace it, if required.

Replacing the Cartridge Filter

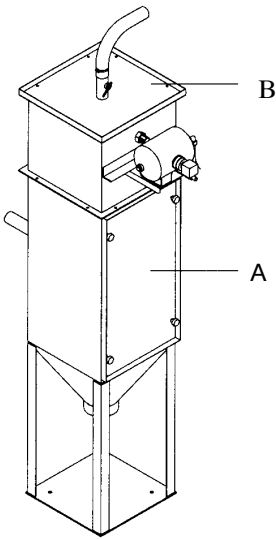

Fig. 5-1

To remove the cartridge filter, proceed as follows:

- Open the door located into the filter body (Pos. A)
- Remove the valve body cover (Pos. B)

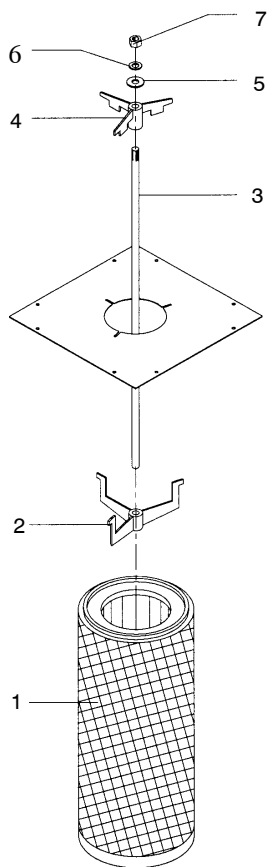

Fig. 5-2

See Figure 5-2.

- Unscrew and remove the cartridge locking nut (7)
- Remove the cartridge filter through the filter body door
- Remove the threaded bar from the cartridge filter.

Dispose of old cartridges in compliance with the relevant regulations.

Keep the other parts (2 – 7) to reuse them when new filters are installed.

The gasket surface on the cartridge holder plate should be perfectly clean.

Installing a New Cartridge Filter

Check the new cartridge for damages, such as:

- Dents or cuts in the rubber gaskets
- Dents in the covers or end caps
- Dents or holes on the filter bend
- Bent or dented inside wall
- Bent or dented outside wall

DO NOT INSTALL DAMAGED CARTRIDGE FILTERS

- If the filter was damaged during delivery, please contact the carrier.
- If not, contact your Nordson representative.

See Figure 5-2.

1. Install the centring profile (2) into the cartridge filter (1) so that most of it is located inside the filter.
2. Install the threaded bar (3) into the cartridge filter (1) introducing it through the centring profile (2) and inserting the threaded part into the block at the bottom of the filter. Tighten by hand.

DO NOT OVERTIGHTEN!

3. The filter can now be installed into the filter module. Insert it through the opening under which the filter must be installed and lock it using the "T" handle on the threaded bar (3). Lift the filter and place it below the cartridge fixing plate. Place the filter support (4) on top of the bar threaded part (3) introducing the long end into the filter. Check that the "T" handle on the threaded bar (3) is aligned with the filter support slot (4) and that a threaded part of the bar (3) protrudes from top of the filter support (4).
4. Place the flat washer (5) and the locking washer (6) on top of the threaded part (3) of the filter support bar (4). Tighten the nut (7) on the threaded bar (3). Align the teeth of the filter support (4) with the slots and the holes in the cartridge fixing plate.
5. Once aligned, tighten the nut (7) to the filter until the bottom of the filter support (4) touches the top of the centring profile (2).

This will ensure the proper compression of the gaskets and the proper installation of the filter.

DO NOT OVERTIGHTEN!

AN EXCESSIVE TIGHTENING COULD DAMAGE BOTH THE FILTER AND ITS SUPPORT!

6. Check the fixing between the cartridge gasket and the cartridge fixing plate.

Section 6

Troubleshooting



WARNING: Allow only qualified personnel to perform the following tasks. Observe and follow the safety instructions in this document and all other related documentation.

Introduction

This section contains troubleshooting procedures. These procedures cover only the most common problems that you may encounter. If the problem cannot be solved with the information given here, contact the local Nordson representative for help.

Problem	Possible Cause	Corrective Action
Cartridge cleaning failure	Compressed air supply failure	Check the air supply circuit pressure Check that no valve supplying compressed air to the tank is closed or cut off Check that the solenoid valve is properly supplied
Exhaust powder bag filling failure or excessive	Improper adjustment of the lock	Adjust the air lock to properly relieve the filter Perform system functional checks
Powder leaks from the system	Exhaust powder bag full Exhaust powder bag not mounted Partly or fully closed adjustment air lock	Remove the full bag and mount a new one Properly mount the exhaust powder bag Properly adjust the lock position Perform system functional checks

Section 7

Parts

Introduction

To order parts, call the Nordson Customer Service Center or your local Nordson representative. Use the parts list, and the accompanying illustration, to describe and locate parts correctly.

Using the Illustrated Parts List

Numbers in the Item column correspond to numbers that identify parts in illustrations following each parts list. The code NS (not shown) indicates that a listed part is not illustrated. A dash (—) is used when the part number applies to all parts in the illustration.

The number in the Part column is the Nordson Corporation part number. A series of dashes in this column (- - - - -) means the part cannot be ordered separately.

The Description column gives the part name, as well as its dimensions and other characteristics when appropriate. Indentions show the relationships between assemblies, subassemblies, and parts.

Item	Part	Description	Quantity	Note
—	000 0000	Assembly	1	A
1	000 000	• Subassembly	2	
2	000 000	• • Part	1	

- If you order the assembly, items 1 and 2 will be included.
- If you order item 1, item 2 will be included.
- If you order item 2, you will receive item 2 only.

The number in the Quantity column is the quantity required per unit, assembly, or subassembly. The code AR (As Required) is used if the part number is a bulk item ordered in quantities or if the quantity per assembly depends on the product version or model.

Letters in the Note column refer to notes at the end of each parts list. Notes contain important information about usage and ordering. Special attention should be given to notes.

Parts List

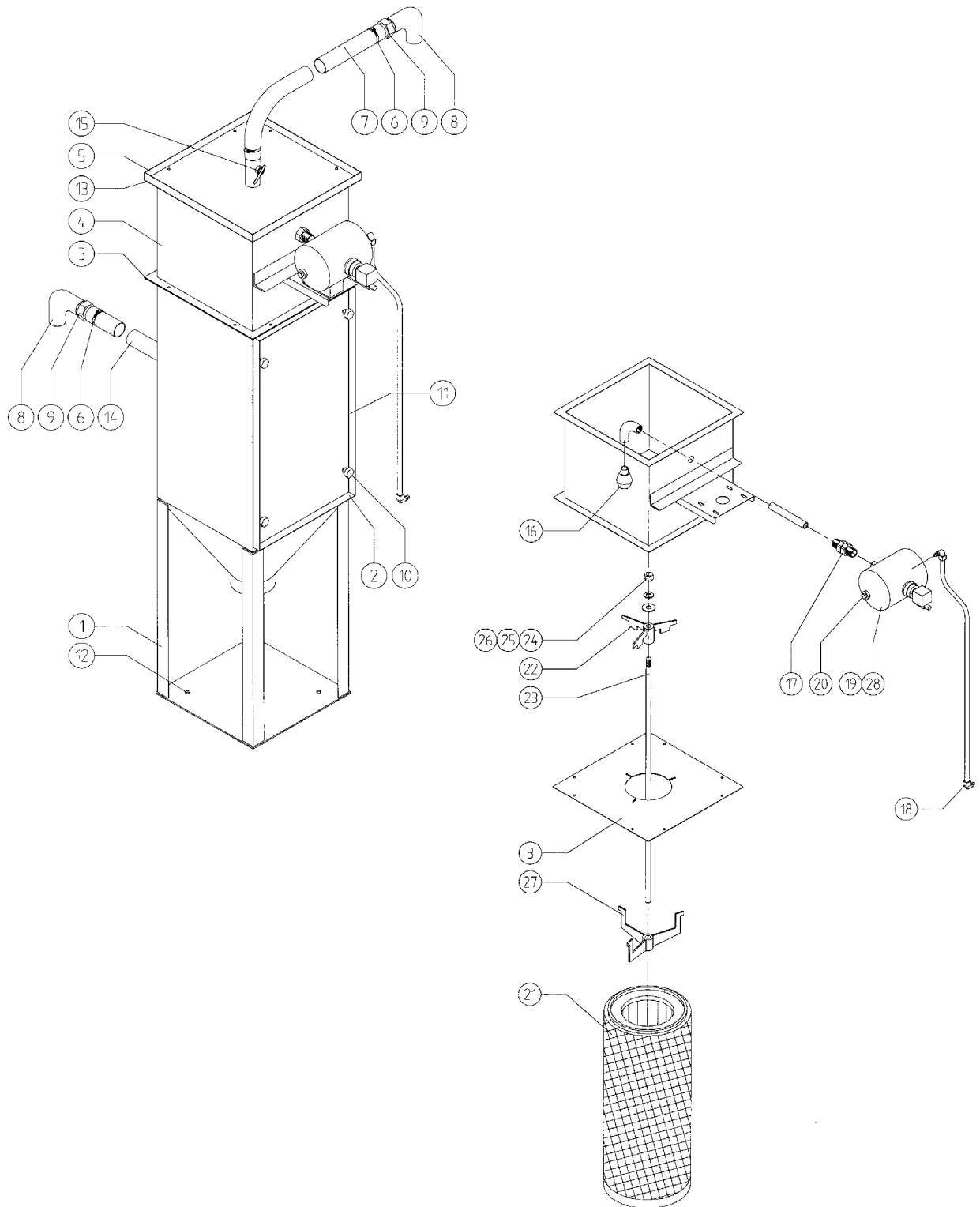

Fig. 7-1

Item	Part	Description	Quantity
1	AS 6326-1001	Filter wooden parts	1
2	AS 6326-1002	Inspection door	1
3	AS 6326-1003	Cartridge filter holder plate	1
4	AS 6326-1004	Valve body	1
5	AS 6326-1005	Plenum cover	1
6	91005146	Metal strap for tube	4
7	91005257	ø50 DB.PL1 transparent hose	4
8	91005038	ø50 PVC elbow	2
9	91005035	ø50 PVC nipple	2
10	769511	M8 F Flywheel	4
11	767211	Orthogonal "U" gasket	2.5
12	91005068	M10x45 Insert	4
13	91005032	25x5 AD Gasket	7
14	91005257	ø50 DB.PL1 Transparent hose	3
15		ø50 Air lock	1
16	768408	3/4" Cleaning head	1
17	91CO6322	Wall mount mod. PTD 306 3/4"	1
18	5058	1/4" M – 10 – S6520 "L" fitting	2
19	Z0900EL6466	Cable 2+1	10
20	91005161	1/4" mod Plug. 2611	1
21	Z0900CO10042	ø330 – H=800 Cartridge filter	1
22	Z0900CO10252	Double centering star for cartridge	1
23	Z0900CO10253	Complete drawbolt for double centering star	1
24	984178	5/8" – 11 Nut	1
25	983090	5/8" Flat washer	1
26	983440	5/8" Washer	1
27	174722	Centering star	1
28	91CO6321	Tank + valve F.I. + 24V dc timer VEP 206	1

Section 8

Technical Data

Electrical

Tension (with timer)	24 VAC
Tension (without timer)	24 VDC
Frequency	50 Hz
Flow rate	1020 m ³ /h

Dimension

Height	2150 mm
Width	460 mm
Depth	460 mm
Maximum depth	850
Weight	60 kg

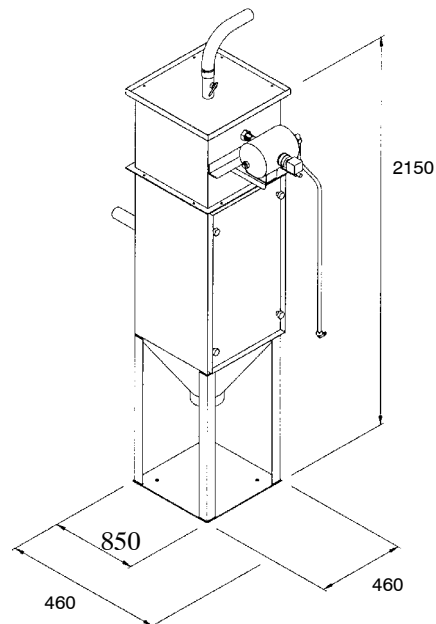

Fig. 8-1

Packaging and Handling

The unit is usually shipped packed in a wooden cage.

When packed, it should be handled using normal lifting means.

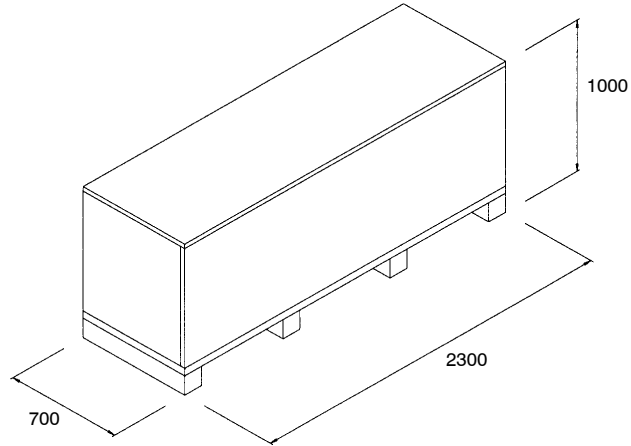

Fig. 8-2

If the unit weight is not high, the final placement can be carried out manually without using the normal lifting means.

Noise

Less than 70 dBA measured at a distance of 1m from the surface of the unit at a height of 1.6 m.

Pneumatic

The air supply should be equal to 2 °C dewpoint, oil free or clean and dry, filtered at 5 μ at a minimum pressure of 6.5 bar.